

LaGrange County Regional Utility District
P.O. Box 270
LaGrange, Inn 46761
Ph. 260.499.6349
Fax. 260.499.6350

Re: Region C Wastewater Project

Dear Potential New Wastewater Customer,

LaGrange County Regional Utility District Board of Trustees approved the Preliminary Engineering Report (PER) on December 21, 2017, for submission to Indiana State Revolving Fund (SRF). In anticipation of their approval of the PER we would like to have property owners fill out an informational sheet and return it to the district. This will allow the project engineers to get the information of where some of the utilities on your property is located. If you do not know for sure that is ok as well. Please follow the instructions on the enclosed forms. If you have any questions please feel free to contact us and we will be more than glad to help you through the form.

Also, in the next couple of weeks, you will be receiving an informational packet with important information regarding easements (both construction and permanent), guidelines of connecting to the grinder pump and much more information that is very important for you to retain for the future.

Respectfully,

Adam Sams

**LaGrange County Regional Utility District
Box 270
116 East Wayne Street
LaGrange, IN 46761**

Existing Septic Tank, Water Well and Underground Utilities Location Information

(Please type or print clearly)

Name(s) of Property Owner: _____

Address of Property: _____

Mailing Address for Property Owner (if not same as address of property):

Contact Phone Number: _____

Secondary Contact Phone Number: _____

Name of Resident if different than above: _____

Date _____

SHOW ON SKETCH of following page (also see sample sketch on following page):

1. Indicate North direction with arrow.
2. Locate streets and alleys.
3. Locate any drinking water wells on the property.
4. Locate buildings on lot.
5. Show lot lines.
6. Sketch location of existing septic tank and absorption field, cleanouts and sewer laterals from house to septic tank
7. Show location of off street parking
8. Show location of access routes for boat removals, docks, etc. from road side to lake side
9. Show location of underground electric lines, communication lines, gas lines, water lines, drain tiles, irrigation lines, etc.

Sketch on Back Side

Sample Sketch

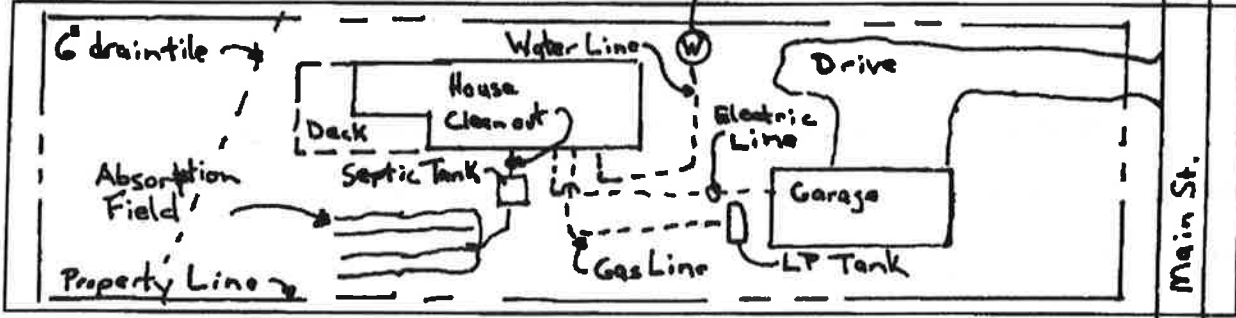

Sketch

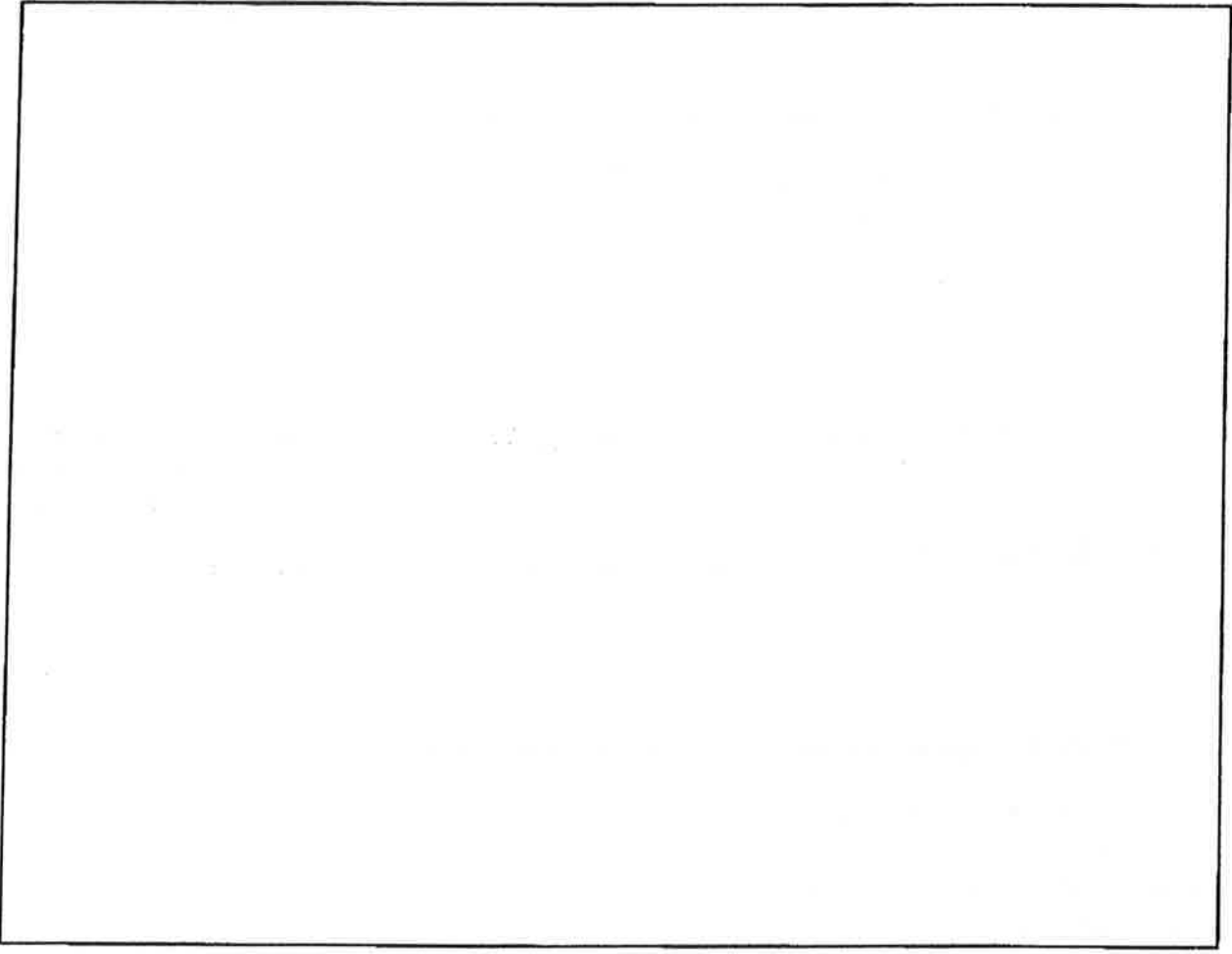

Use separate piece of paper if needed to provide information.
Upon completion, return this document to the District via hand delivery, mail or email. Drop off or mail to:

LaGrange County Regional Utility District
Box 270
116 East Wayne Street
LaGrange, IN 46761
Or email to Jeanette Combs at: lcrudistrict@gmail.com